

LOTS 43, 44, 45, 46, 47 AND 48, BLOCK 91, LAKE WANDAWEGA SUBDIVISION, A SUBDIVISION LOCATED IN TOWN 3 NORTH, RANGE 16 EAST OF THE FOURTH PRINCIPAL MERIDIAN, TOWN OF SUGAR CREEK, WALWORTH COUNTY, WISCONSIN.

NOTE: LOT TO BE SURVEYED AND PROPOSED DWELLING TO BE STAKED UPON NOTIFICATION BY THE ABOVE NAMED CLIENT.

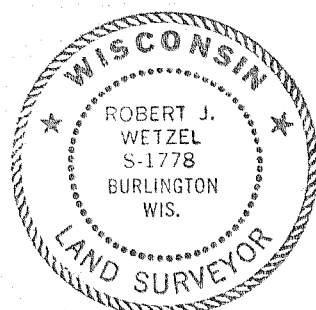

THIS IS NOT AN ORIGINAL PRINT
UNLESS THIS SEAL IS RED.

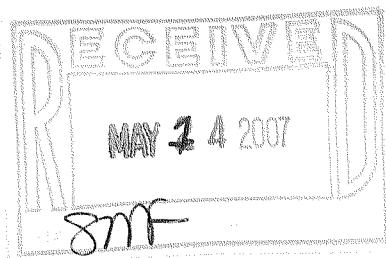
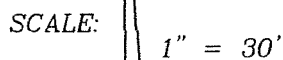
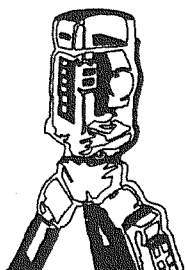

B.W. SURVEYING, INC.

LAND SURVEYS
MAPPING AND PLANNING
412 N. PINE STREET
BURLINGTON, WI 53105
(262)-767-0225

Robert J. Wetzel
ROBERT J. WETZEL S-1778

OCTOBER 23, 2006
DATE

7424
JOB NUMBER

GLW-163

316-1907